

# SL-A520-32 MASSAGE CHAIR

**SAVE THESE INSTRUCTIONS**

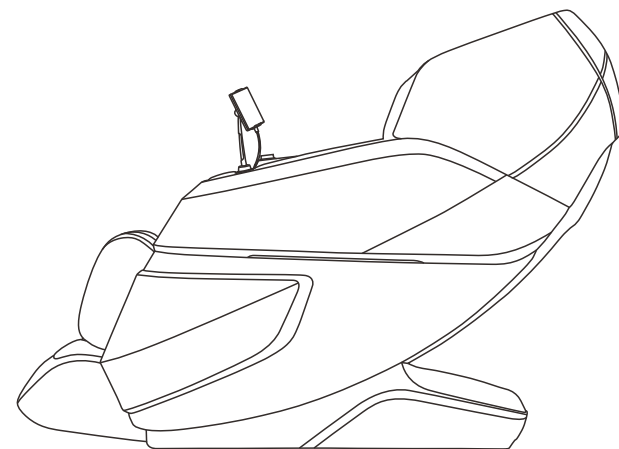

## A520-32 MASSAGE CHAIR

— Operation Instructions —

Thanks for purchasing this product. Please read this manual instruction carefully in order to know how to use this product correctly before operation. Please pay more attention to some important safety warning and keep this manual book properly for future use.

Note: Our company reserves the right to change and explain the design of the product. If there is some difference between the product function in market circulation and the description in the manual, it is a normal update of the product, and our company will not inform you otherwise. The specific product function and color shall prevail in kind.

## CONTENTS

### Before use

---

Safety precautions	02-05
Installation parts	06
Place massage chair	07-08
Before use	09
Product structure	10-14

### Usage method

---

Operation Instructions	15-29
Massage close	29

### Maintain

---

Cleaning and Maintenance	30
--------------------------	----



### Important

---

Troubleshooting	31
Product Specifications	32

## Safety Precautions must be observed

- Please read all relevant instructions carefully before use.
- The notes marked here will help you to use the product safely and correctly.
- In order to clearly indicate the extent of harm and damage, precautions are divided into **"Warning"** and **"Caution"** that may be caused by incorrect use. Both of them are important for safety and must be followed.

 <b>Warning</b>	Indicates that serious injury or death may result from improper use.
 <b>Caution</b>	Indicates that misuse may cause minor injury or property damage.

- Please pay attention to the symbol before each safety item.

 <b>Forbidden</b>	Absolute prohibition
----------------------------------------------------------------------------------------------------	----------------------

### The following populations should not use this product

 <b>Forbidden</b>	<ul style="list-style-type: none"> <li>■ The device is not intended for use by persons (including children) with physical disabilities, sensory or neurological impairments or who lack experience and common sense, unless they are supervised and instructed in the use of the device by those responsible for their safety. Children must be supervised to ensure they do not use tools for play.</li> <li>■ Patients with osteoporosis.</li> <li>■ Patients with severe heart disease and wearing implantable medical devices such as pacemakers and defibrillators that are susceptible to electromagnetic waves.</li> <li>■ People who have a fever (above 38 degrees ).</li> <li>■ Pregnant women or shortly after childbirth and during their menstruation period.</li> <li>■ People who follow medical advice and are prohibited from receiving massage due to thrombosis, aneurysm, severe varicose veins, or other circulatory diseases. Within two weeks after the appearance of blood clots, it is strictly prohibited to massage any form of body parts that have blood clots.</li> <li>■ Patients who are injured or have a skin disease.</li> <li>■ When unsupervised, any children are under the age of 14 and those unconscious are not allowed to use this product.</li> <li>■ People who require rest or feel unwell as instructed by a doctor.</li> <li>■ People with spinal abnormalities or scoliosis are prohibited from receiving this product due to medical advice due to other diseases.</li> <li>■ People whose bodies are wet are forbidden to use this product.</li> <li>■ This product has a hot surface. Persons insensitive to heat must pay attention when using this product.</li> </ul>
---------------------------------------------------------------------------------------------------------	------------------------------------------------------------------------------------------------------------------------------------------------------------------------------------------------------------------------------------------------------------------------------------------------------------------------------------------------------------------------------------------------------------------------------------------------------------------------------------------------------------------------------------------------------------------------------------------------------------------------------------------------------------------------------------------------------------------------------------------------------------------------------------------------------------------------------------------------------------------------------------------------------------------------------------------------------------------------------------------------------------------------------------------------------------------------------------------------------------------------------------------------------------------------------------------------------------------------------------------------------------------------------------------------------------------------------------------------------------------------------------------------------------------------------------------------------------------------------------------------------------------------------------------------------------------------------------------------------------------------------------------------------------------------------------------------------------------------------

## Safety Precautions must be observed

### Important safety warnings

 <b>Warnings</b>	<ul style="list-style-type: none"> <li>■ Keep children away from the movable parts of this product.</li> <li>■ Use the well-grounded power supply unit suitable for this product.</li> <li>■ Pull out the plug after use or before cleaning to avoid any damage to physical injury or the product.</li> <li>■ Operate this product as instructed in this manual.</li> <li>■ Do not use any parts or accessories which are not recommended.</li> <li>■ Do not use this product outdoors.</li> <li>■ Do not use near open flames such as stoves, and do not smoke while using.</li> <li>■ Do not use heating equipment such as electric blankets on this product.</li> <li>■ Do not sit on the back of the chair, leg massagers, shoulders, armrests, or stand on the seat.</li> <li>■ Please read the Operation Instructions carefully before operation.</li> <li>■ Never use this product for any other purpose not listed in the manual .</li> <li>■ 20 minutes of usage each time is recommended.</li> <li>■ Do not use this product if the cover or leather is broken or damaged.</li> <li>■ Do not drop anything into this product.</li> <li>■ Never fall asleep while using this product.</li> <li>■ Do not use this product if you are drunk or feel unwell.</li> <li>■ Do not use this product within one hour after a meal.</li> <li>■ Do not use this product with excessive force to avoid any injury.</li> <li>■ Do not use for purposes other than massage.</li> <li>■ If the supply cord is damaged, to avoid danger, it must be replaced by a professional from the manufacturer, its maintenance department or similar department</li> </ul>
--------------------------------------------------------------------------------------------------------	-------------------------------------------------------------------------------------------------------------------------------------------------------------------------------------------------------------------------------------------------------------------------------------------------------------------------------------------------------------------------------------------------------------------------------------------------------------------------------------------------------------------------------------------------------------------------------------------------------------------------------------------------------------------------------------------------------------------------------------------------------------------------------------------------------------------------------------------------------------------------------------------------------------------------------------------------------------------------------------------------------------------------------------------------------------------------------------------------------------------------------------------------------------------------------------------------------------------------------------------------------------------------------------------------------------------------------------------------------------------------------------------------------------------------------------------------------------------------------------------------------------------------------------------------------------------------------------------------------------------------------------------------------------

### Operating environment

 <b>Caution</b>	<ul style="list-style-type: none"> <li>■ Do not use this product in a very moist environment such as the bathroom.</li> <li>■ Stop using this product immediately when the ambient temperature changes sharply.</li> <li>■ Do not use this product in any heavily-dusty or caustic environment.</li> <li>■ Do not use this product in a small space or a place without good ventilation.</li> </ul>
---------------------------------------------------------------------------------------------------------	-----------------------------------------------------------------------------------------------------------------------------------------------------------------------------------------------------------------------------------------------------------------------------------------------------------------------------------------------------------------------------------------------------

## Safety Precautions (Must be observed)

### Storage conditions



Caution

- Storage room temperature: 5 °C to 40 °C.
- Relative humidity (RH) between 20% and 80%; free of corrosive gases, and a well-ventilated room.

### Product service and maintenance



Caution

- This product should be maintained by the service center designated by the manufacturer only. No user should disassemble or maintain it without permission.
- Do not forget to turn off the main power switch after usage.
- Do not use this product if the power socket becomes loose.
- If this product will be left unused for a long period of time, it is necessary to roll up the power cord of this product and store this product in a dry and dust-free environment.
- Do not store this product at a high temperature or near open flame. Avoid prolonged exposure to direct sunshine.
- Please clean this product with dry cloth. Never use thinner, benzene or alcohol.
- The mechanical components of this product are specially designed and manufactured, so no special maintenance is needed.
- Do not use a sharp object to stab at this product.
- Do not roll or pull this product on any uneven ground. Instead, it should be lifted before moving.
- Please use this product intermittently. Do not keep it working continuously for a long period of time.

### Solutions to ordinary malfunctions



Caution

- If the motor sounds during operation of this product, this is the normal operation sound.
- If the controller cannot work normally, check whether the plug and the power socket are connected reliably, and whether the power switch is turned on.
- If the rated working time is over, this product will automatically activate the power-off button; If this product keeps operating for a long period of time, the temperature protector will stop this product automatically. The product can be used again after half an hour.

## Safety Precautions (Must be observed)

### Safety precautions



Caution

- Check whether voltage is consistent with the specification of this product.
- Never insert or pull out the plug with a wet hand.
- Do not let water flow into this product to avoid electric shock or cause damage to this product.
- Do not pull the power cord when plugging or unplugging it. Rough handling is forbidden.
- Do not damage the wire or modify the circuit of this product.
- Do not clean live parts of this product with a wet cloth such as a power switch and plug.
- Be away from this product in case of power failure to avoid any injury if power is restored suddenly.
- Stop using this product at once while it works abnormal, and consult your local supplier.
- Stop using this product if you feel unwell, and consult your health care practitioner.

## Installation parts

### Calf installation instruction

- 1.Insert the harnesses and air hose of the footrest into the front socket of the frame assembly respectively (Figure 1).
- 2.After the harnesses connection is completed, open the footrest fixing covers on both sides of the frame assembly (Figure 2).

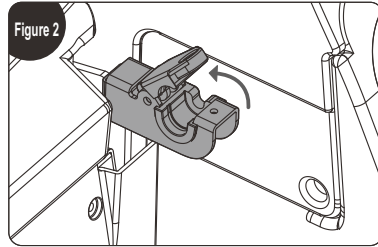
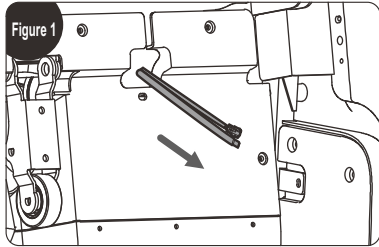

- 3.Lift the footrest, put it into the slot then flip the fixing cover, and finally fix it with 2 M4 screws (Figure 3)

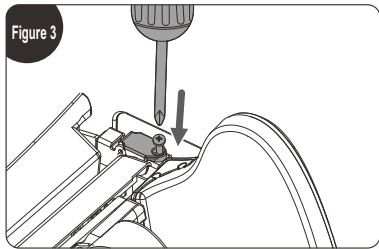

### Remote control holder installation instruction

Align the threads on the bracket assembly support knob with the corresponding thread position of the bracket mount on the armrest(Figure 1), turn clockwise and tighten to secure (Figure 1)

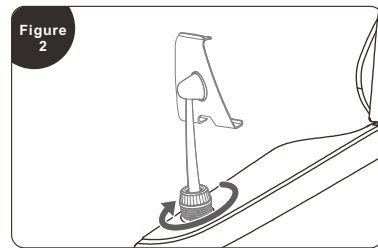
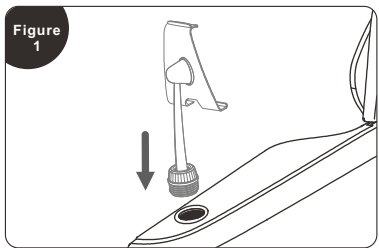

## Place massage chair

### Installation placement

**Make sure there is enough space for the massage chair can be tilted at least 10 cm.**



Do not expose the massage chair directly to high temperature environment due to sunlight(such as: in front of heating equipment), and place it to where can avoid high temperature and direct sunlight. It is recommended to lay a soft cushion for long-term use in a designated location. When laying the cushion, the size of the cushion should be enough to cover. Keep the range where the machine touches the floor and the range where your feet touch the floor.

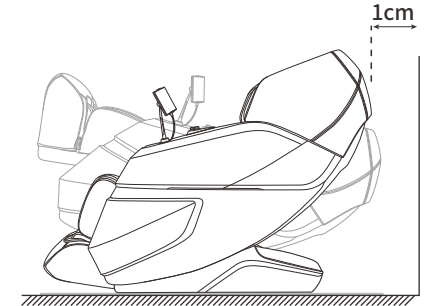

### Product lift instruction

**Require team work to lift and move the chair to avoid injury.**



1. Please lift the massage chair to move it on vulnerable ground such as wooden floor.
2. When moving on a similar wooden floor, it is recommended to lift it. Avoid damage to the casters. When the floor is lifted and moved to the designated position, be careful to keep your hands out of the way to avoid injury, and be careful of your feet being crushed. Do not let go of the unit until the floor is completely flat, the floor may be damaged, therefore, it is recommended to place mats, etc. on the floor.

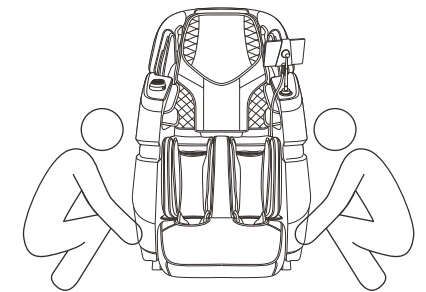

## Place massage chair

### Move method

Use the rear casters to move the massage chair. Move the chair by tilting it down and backward about 45° as shown in the diagram.

**NOTE:** Excessive force to title will cause the chair to tip over completely and product damage.

1. Before moving, please shut down the machine properly to reset the whole machine, and then cut off the power.
2. Please keep the chair vacant when moving. (People, pets or clutter will not be able to stay on the chair.)
3. When moving, do not cross a drop barrier higher than 2mm or a gap greater than 5mm.
4. When using casters to move this product, single continuous movement is not supported; if the distance exceeds 50 meters, please make this product move slowly and evenly.

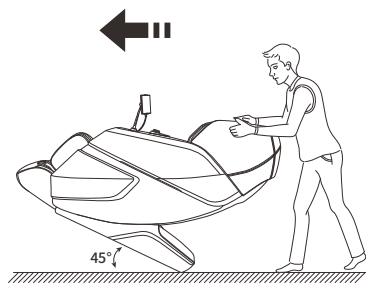

### How to disassemble and use headrest cushion and backrest cushion

Using a headrest cushion can reduce the intensity of kneading massage on the neck and shoulders, and you can decide whether to use a headrest cushion according to your needs (recommended to use a headrest cushion). The backrest cushion and the backrest are connected by a zipper (1), and the headrest cushion and the backrest cushion are connected by a zipper (2).

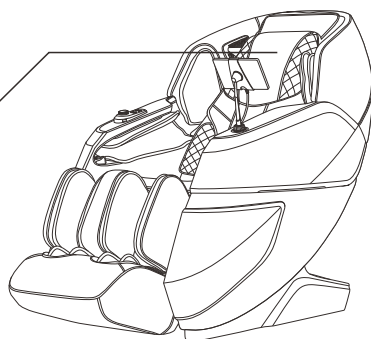
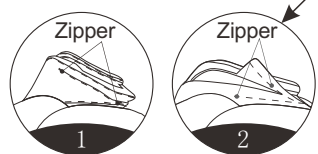

## Before use

### Check around



Make sure that there are no people, pets and other objects around the unit.

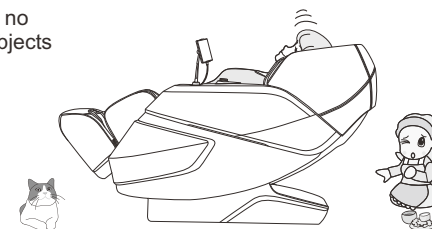

### Make sure there are no foreign objects in the gaps of the machine



Before massaging, make sure that no foreign objects are caught in the legs, feet, etc.  
Under no circumstances allow hands, feet, and head to penetrate into the area between the lower leg mechanism and main body, or the area between the armrest and the capsule.  
Under no circumstances should hands, feet, or head sink under the fabric or leather covering of the massage area.

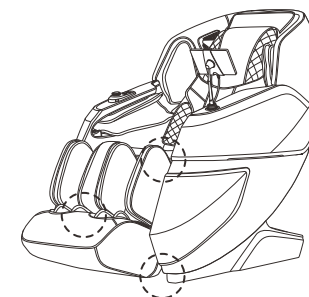

### Turn on the power

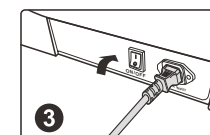
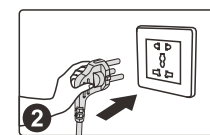
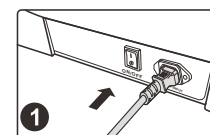

- Please check the power cord and plug for damage before use.
- Please supply power to this product in accordance with the working power requirements of this product's calibration.
- It is strictly forbidden to use a power supply other than the nominal power supply of this product.
- It is strictly forbidden to connect various power conversion devices without authorization to supply power to this product.

## Product structure

### Description of Components

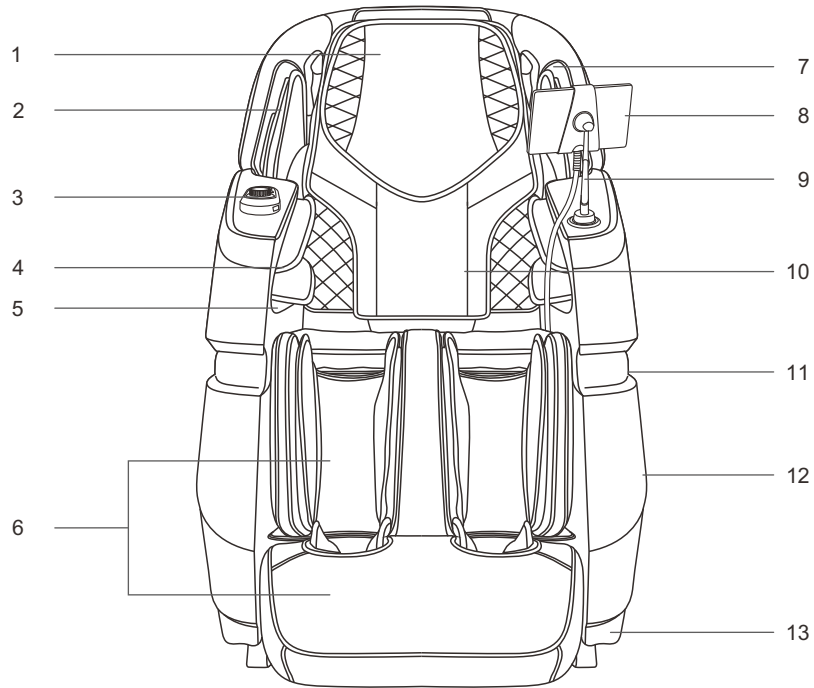

- |                         |                         |
|-------------------------|-------------------------|
| 1.Head cushion          | 7.Speaker cover         |
| 2.Shoulder air pressure | 8.Remote control        |
| 3.Armrest shortcut keys | 9.Remote control holder |
| 4.Arm air pressure      | 10.Back cushion         |
| 5.Health sensor         | 11.LED light            |
| 6.Leg massage unit      | 12.Armrest              |
|                         | 13.Side cover           |

## Product structure

### Schematic view of functional distribution

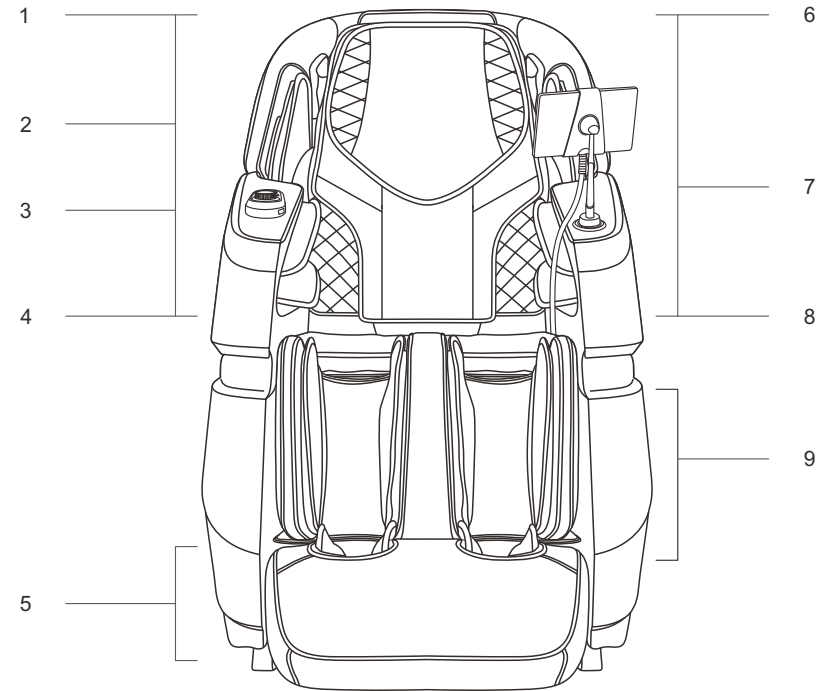

- |                                              |                           |
|----------------------------------------------|---------------------------|
| 1.Right side of the head                     | 6.Both sides of the head  |
| • Voice control function                     | • 3D digital audio        |
| • Built-in voice control Microphone          | • Music player            |
| 2.Shoulder                                   | 7.Head and neck to bottom |
| • Airbag massage                             | • Dual massage mechnaism  |
| 3.Arm                                        | 8.Waist                   |
| • USB charging port                          | • Heating function        |
| • Airbag massage                             | • Airbag massage          |
| 4.Plam                                       | 9.Leg                     |
| • Airbag massage                             | • Airbag massage          |
| • Salient massage hand with magnetic therapy | • Kneading massage        |
| 5.Leg                                        | • Calf roller massage     |
| • Roller massage                             |                           |
| • Airbag massage                             |                           |
| • Electrically adjustable foot telescopic    |                           |
| • Automatic leg length detection             |                           |
| • Calf anti-pinch                            |                           |

## Product structure

### Remote controller keys instruction

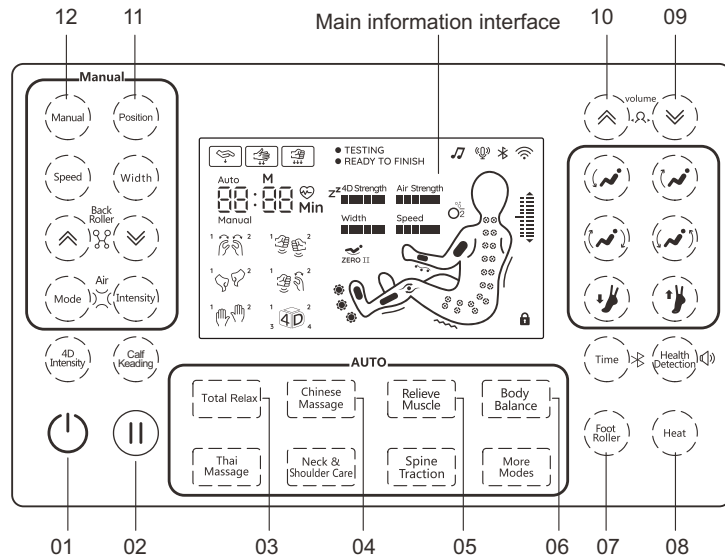

01. On-off key: turn on or off the massage chair function.
02. Pause button: pause massage or exit pause massage.
03. Total Relax key : turn on the Total Relax function; When it is turned on, background music will be played automatically.
04. Chinese Massage key : turn on the Chinese Massage function; When it is turned on, background music will be played automatically.
05. Relieve muscle key : turn on the Fatigue Recovery function; When it is turned on, background music will be played automatically.
06. Body Balance key : turn on the Gentle massage for full body relax.
07. Foot roller key: open or close the roller, Roller strength is adjustable in 3 levels.
08. Heat key: press it to turn on or off the back heating function.
09. Down key / volume down key: short press it to adjust the shoulder position, long press it to decrease the volume.
10. Up key / volume up key: short press it to adjust the shoulder position , long press it to increase the volume.
11. position key: select different massage parts.
12. manual key: open manual operate, there are 11 kinds of massage techniques in manual key for optional; In manual mode, long press to switch into the upper back mechanism and lower back mechanism control. Default start from upper back mechanism.

## Product structure

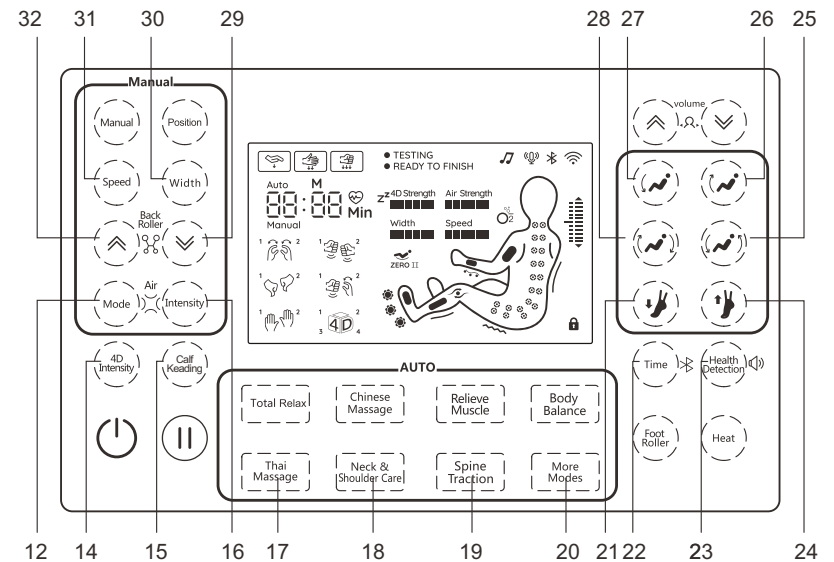

13. Air mode key: select different air pressure modes.
14. 4D intensity adjustment key: press it to adjust 4D intensity.
15. Calf kneading key: turn on or off the calf kneading function.
16. Air intensity key: adjust the air pressure intensity.
17. Thai massage key: turn on the Thai massage function.
18. Neck & Shoulder Care key : turn on the Neck & Shoulder Care function.
19. Spine Traction: turn on the Waist Care function.
20. More programs key: cycle through the adjustments for more automatic modes.
21. Foot extension key: motorized adjustment of foot extension.
22. Timing / Bluetooth key: short press to adjust the massage time, long press 3 seconds to turn on or off the Bluetooth function.
23. Health detection / Voice broadcast key: short press to start or end the health detection, long press to turn on or off the voice broadcast function.
24. Foot shortening key: motorized adjustment of foot shortening.
25. Seat up Key: adjust the massage chair angle upward.
26. Leg mechanism up key: leg mechanism upward adjustment.
27. Leg mechanism down key: leg mechanism downward adjustment.
28. Sitting down key: adjust the massage chair angle downward.
29. Down key: in manual model , back mechanism downward adjustment.
30. Width key: adjust the width of the back mechanism, with 5 levels adjustable.
31. Speed key :adjust the speed of the back mechanism, with 5 levels adjustable.
32. Up key: in manual mode back mechanism upward adjustment.

## Product structure

### Description of armrest shortcut keys

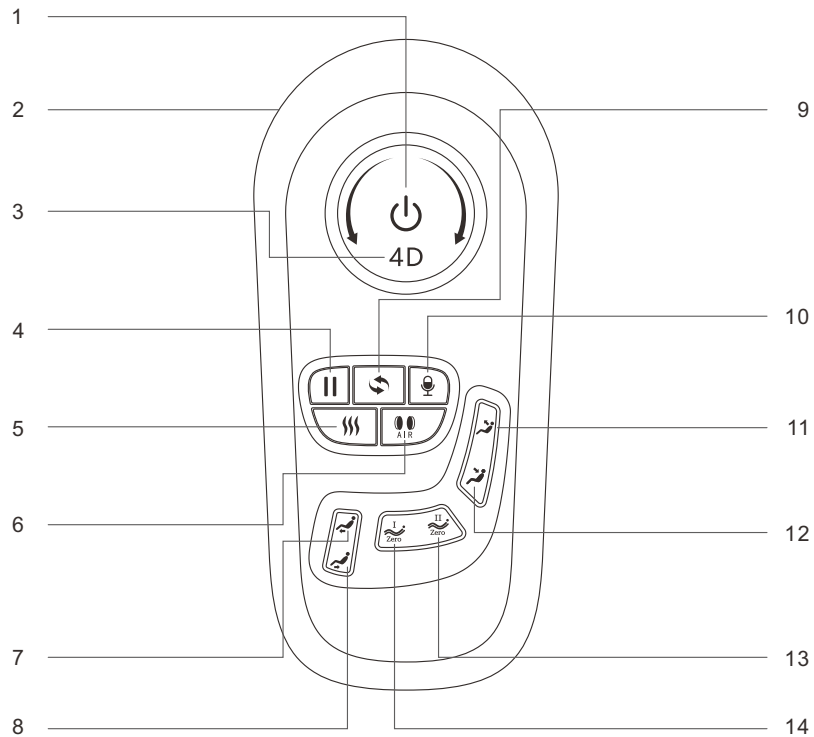



1. Power key: A long press of this key can turn the massage chair on or off.
2. USB charging port: 18W fast charge.
3. 4D intensity key: Adjust massage intensity (Decrease to the left, increase to the right).
4. Pause key: Pause massage or exit from pause massage.
5. Heating key: on/off back heating.
6. Air pressure key: on/off air pressure massage function.
7. Calf-up: adjust the footrest upwards.
8. Calf-down: adjust the footrest downwards.
9. Auto mode key: Select Auto mode(all auto mode circulate in order).
10. Voice control key: Press and hold to turn on or off the voice function, and short press to wake up.
11. Back part lifting: adjust the lifting of backrest.
12. Back part reclining: adjust the reclining of backrest.
13. Zero gravity2: Adjust the chair angle to zero gravity2.
14. Zero gravity1: Adjust the chair angle to zero gravity1.

## Operation Instructions

### I. Start massage

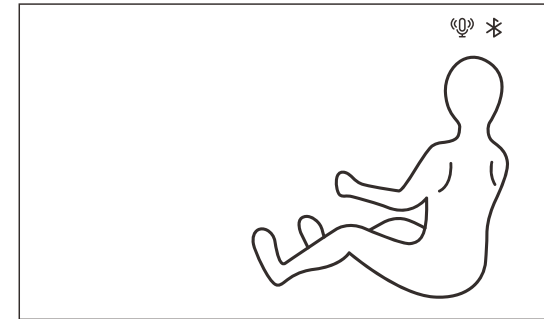
1. Press the power key on remote controller or on armrest to start the massage, the default is Auto mode 1.



2. The massage chair will adjust the angle to zero gravity automatically after starting the massage. (Zero gravity angle suitable for massage) After zero gravity, the massage will start body scanning, Please keep your body and sitting posture close to the massage chair.
3. Body scanning. Start body scanning after adjusting the angle, Users need to lie back against the massage chair and wait for the body scanning to complete.
4. After body scanning, Remote control or broadcast will prompt user to adjust shoulder position. If massage hand suit for your shoulder position, no need to adjust shoulder position, While massage hand not suit for shoulder position, please use shoulder Up key  or Down key  to adjust. After 20 seconds, start massage. The default will use current massage hand position if no operation over 20 seconds. Noted: Repeated selection of the same auto can be skipped directly into the massage

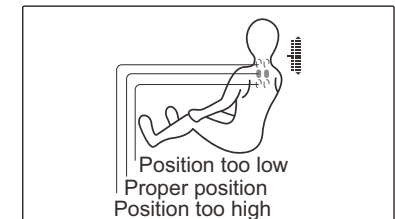
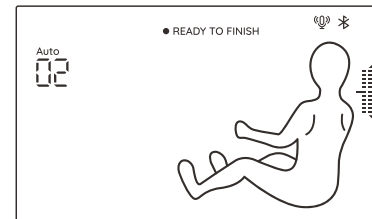

### II. Automatic program (please use this function after the chair is turned on)

1. Automatic program selection
  - (1). Click on the automatic program button area on the remote control, then select the automatic program to start massage.
  - (2). Totally 18 kinds of auto programmes. Including 7 kinds of special modes, they are shown on the remote controller already others need to press the "more" to optional.
    - special mode: Total Relax, Chinese Massage, Relieve Muscle, Body Balance, Thai Massage, Neck & Shoulder Care, Spine Traction
    - Others: Superior Enjoyable, Full-body Stretch, Leg&foot Relieve, President Cosy, Keep Fit, Office Regimen, Health Recharge, Energy Boost, Lunch Break, Back Spa, Sweet Dream.

## Operation Instructions

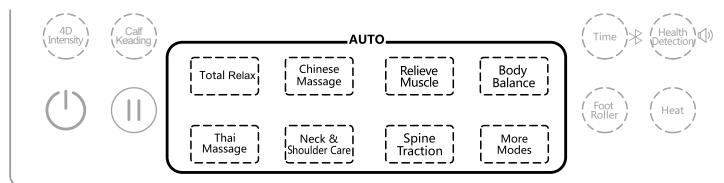

Schematic diagram of automatic massage program selection

### 2. Automatic program introduction

Function	Description	Display
Total Relax	Apply deep pressure on the neck, back and waist, buttocks, and legs by means of kneading, patting, finger pressing techniques mainly to relieve the fatigue on body, allowing the body to better relax.	01
Chinese Massage	By means of Traditional Chinese medicine massage technique mainly, apply 3D massage on the back and waist so as to promote the blood circulation of the back and waist, soothe the meridians and relieve the blockage of the back and waist through massage. It is suitable for people with back and waist pain, and lumbar muscle strain. Massage intensity is gentle.	02
Relieve Muscle	Apply deep pressure on the neck, back and waist, buttocks, and legs by means of kneading, patting, finger pressing techniques mainly to relieve the fatigue on body, allowing the body to better relax.	03
Body Balance	Apply full air massage mainly, with the use of airbags for cross circulation of kneading and pressure, so as to promote blood circulation, alleviate pain in various body parts, and deeply relieve muscle fatigue. (Remarks: full air massage mainly, with frequent air massage action)	04
Thai Massage	Mainly use calf and backrest electric push rod to clamp legs, hands and shoulders with the aid of air massage, and then apply stretching massage, while the movement holds against the back and waist for 3D medical massage, so that the body is in the Thai stretching state. It is suitable for people under high stress to improve their head-down on chest and humpback. Massage intensity is strong.	05
Neck & Shoulder Care	Massage the neck and shoulders by means of kneading and stretching techniques mainly, and also the upper back by medical massage, and then press the Jianjing acupoint to relieve cervical spondylosis and achieve the effect of relaxing the muscles of the neck and shoulders. Massage intensity is gentle, suitable for people working in office and suffering from cervical fatigue.	06

## Operation Instructions

Spine Traction	Massage the waist by means of kneading, patting and medical massage mainly, while the movement holds against the back and waist for 3D medical massage, so as to relieve lumbar spine pain; combined with the thermostatic heat configuration around the waist, maintain a comfortable temperature to bring warm massage experience; with gentle and moderate massage intensity and comfortable temperature, bring warm massage experience.	07
Superior Enjoyable	Apply air massage on the whole body, with the foot roller and calf kneading massage. Calf stretching function is canceled, suitable for the elderly and people suffering stress on back. The massage intensity is gentle.	08
Full-body Stretch	By means of kneading, patting, finger pressing and medical massage techniques mainly, clamp the legs, hands and shoulders with the aid of air massage, and then apply stretching massage to soothe the meridians, promote blood circulation, relieve blockages in the body.	09
Leg&foot Relieve	Massage the shoulders and waist by means of kneading, patting, kneading and patting mainly, apply air massage on the legs and feet for squeezing massage, allowing more soothing leg and foot massage, suitable for sedentary people with low stress on the legs and feet, not only relieving the cervical spine, lumbar spine pain of sedentary people, but also soothing the legs and feet. Massage intensity is gentle.	10
President Cosy	Massage the shoulders, neck, back and waist by means of kneading, patting, kneading and patting mainly, to relieve fatigue, promote blood circulation, and release stress by such deep massage. It is suitable for men, and the massage intensity is moderate.	11
Keep Fit	Massage the shoulders, neck, waist and hips by means of kneading and finger pressing techniques, through the massage on the whole body, to relax the body and mind, and enjoy the queen-level treatment. It is suitable for women, and the massage intensity is gentle.	12
Office Regimen	Massage the shoulders, neck and waist by means of kneading, patting, kneading and patting techniques mainly, to relieve shoulder and neck pain, improve lumbar muscle soreness and maintain lumbar spine through such deep massage. It is suitable for office white-collar and sedentary people, and the massage intensity is moderate.	13

## Operation Instructions

Health Recharge	Deeply massage the whole body by means of kneading, patting and finger pressing techniques, to promote blood circulation throughout the body and prevent blood clots. It is suitable for people who live at home for a long time and do not like to go out, and the massage intensity is moderately gentle.	14
Energy Boost	Massage the waist, shoulders and neck by means of kneading, patting, kneading and patting techniques, to awaken the body's vital energy, stimulate physical energy through such deep massage of the whole body with the massage intensity being heavy, which is suitable for people with strong stress, such as athletes, for stimulating the potential before a race.	15
Lunch Break	Massage the back and waist by means of kneading and patting techniques, and press the Shenyu acupoint, to improve the quality of lunch break, so that the user is more energetic in afternoon work. It is suitable for office workers, and the massage intensity is gentle.	16
Back Spa	Deeply massage the whole body by pressing related acupoints by means of kneading, patting, finger pressing and other massage techniques, to let the stimulation fully reach the deep layer of muscle tissue, feel warm locally combined with the function of hot compress, and regulate the Qi and blood in a bid to achieve the effect of warmth and damp expelling.	17
Sweet Dream	Massage the shoulders, neck, back and waist by means of kneading and medical massage techniques, and press the acupoints of Fengchi and Shenyu, to improve the sleep quality and help sleep. It is suitable for people suffering from poor sleep, and the massage intensity is gentle.	18

### III. Manual program (please use this function after the chair is turned on)







1. Manual button: select "manual" key on the remote controller to switch the "upper back mechanism or lower back mechanism"; Short press it to enter the upper back mechanism massage technique operation, long press it to enter the lower back mechanism massage technique operation.

(1). Upper back mechanism: short press "manual" key on the remote controller, enter the upper back mechanism mode, then press manual key to choose the massage techniques according to personal requirement back mechanism massage technique function keys for massage, including massage area (position) key, mode key, speed key, width key and 4D intensity key, which are used to control the upper back mechanism.

1). There are 11 kinds of massage techniques in the upper back mechanism, including Stop, Knead, Flap I, Flap II, Knead&Tap, Shiatsu I, Shiatsu II, Grasp, 4D I, 4D II, 4D III, 4D IV. Press the manual key to select and enter the manual mode.

2). LCD interface displays techniques.

## Operation Instructions

Function	Massage roller adjustment	
Stop	Speed, width and intensity	
Knead 	Speed and intensity	
Flap I, Flap II 	Speed, width and intensity	
Knead&Tap 	Speed and intensity	
Shiatsu I, Shiatsu II 	Speed, width and intensity	
Grasp 	Speed and intensity	
4D1, 4D2 	Speed and intensity	
4D3, 4D4 	Speed, width and intensity	

5 speed levels adjustable



5 width levels adjustable

5 intensity levels adjustable

(2). Lower back mechanism: long press "manual" key on the remote controller, After entering the lower back mechanism mode, the display screen flashes "Manual", then press manual key to choose the massage techniques according to personal requirement, including massage area (position) key, mode key, speed key, width key, and 4D intensity key, which are used to control the lower back mechanism.

1). There are 5 kinds of massage techniques in the lower back mechanism, including stop, knead I, knead II, knead III, knead IV, press the manual button to select and enter the manual mode.

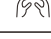
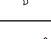
2). LCD interface displays techniques.

Function	Massage roller adjustment	
Stop	Speed and intensity	
Knead I 	Speed and intensity	
Knead II 	Speed and intensity	
Knead III 	Speed, width and intensity	
Knead IV 	Speed, width and intensity	

5 speed levels adjustable

5 width levels adjustable

5 intensity levels adjustable

## Operation Instructions

2. Massage speed: select "**speed**" key on the remote controller, then adjust the "upper back mechanism or lower back mechanism" massage speed according to your massage needs; Users must enter the manual mode before speed adjustment.

- (1). There are 1-5 massage speeds level, with the slowest in 1 level and the fastest in 5 level. The speed cannot be adjusted when the massage technique is stopped.
- (2). LCD interface speed display.

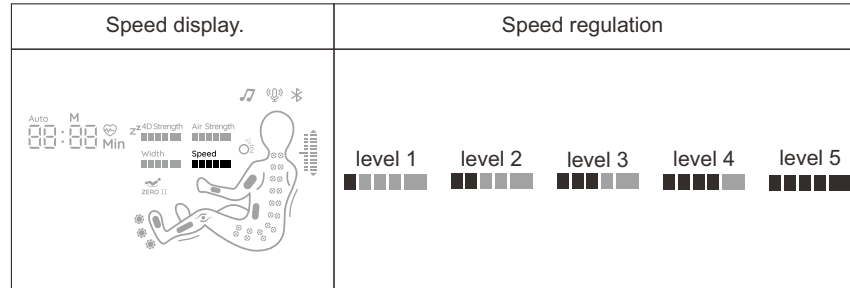

3. Massage width: select "width" key on the remote controller, then adjust the "upper back mechanism or lower back mechanism" massage width according to your massage needs; Users must enter the manual mode before you adjust the width.

- (1). There are 1-5 massage widths level, with the narrowest range being the 1st and the widest range being the 5th. Please do massage width adjust when use the following massage techniques: stop, tap I, tap II, shiatsu I, shiatsu II, 4D III, 4D IV.
- (2). LCD interface displays width.

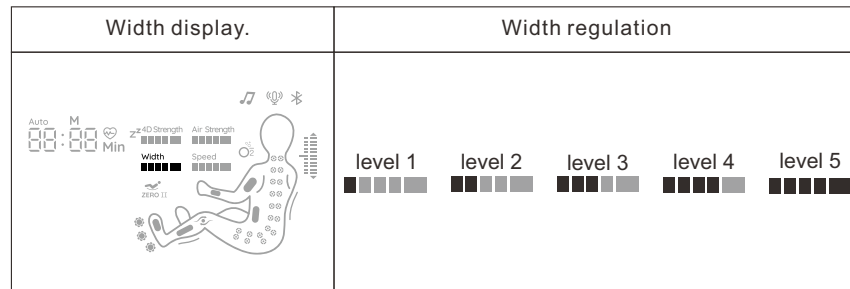

4. Massage area: select "**position**" key on the remote controller, then adjust the "upper back mechanism or lower back mechanism" massage width according to your massage needs; Users must enter the manual mode before you adjust the area.

- (1). Upper back mechanism: press the remote controller "position" key, and select massage area of the upper back mechanism, including spot, partial, upper back, lower back, full back, press the position key to select.

1). LCD interface displays techniques.

## Operation Instructions

Function	Description	
Spot	Fixed-point massage at fixed-point position.	You can adjust the massaged area with the Up key and Down key in the information interface when select the Fixed point massage and Partial massage mode.
Partial	Back and forth massage of small localized area	
Upper	Back and forth massage of upper back	
Lower	Back and forth massage of lower back	
Full	Back and forth massage of full back	

(2). Lower back mechanism: press "**position**" key on the remote controller, and select massage area of the lower back mechanism, including spot, partial, press the position key to select.

1). LCD interface displays techniques.

Function	Description	
Spot	Fixed point massage in a fixed position	The massage position can be adjusted with the "Up" and "Down" keys when selecting the spot.
Partial	Back and forth massage on the waist and hips	

### IV. Air Pressure Function (please use this function after the chair is turned on)

1. Air mode: press "**mode**" key on the remote controller, and then select the air pressure mode according to the massage needs. The air pressure modes include full body, lower body, upper body, and turn off the air pressure function.

Air pressure displayed		
Upper Body 	Lower Body 	Whole-body 

## Operation Instructions

2. Air intensity: Press the **"Intensity"** key on the remote controller, and then adjust the air pressure intensity according to the massage needs. Only under the air pressure function is turned on. air pressure intensity can be operate. There are totally of 5 adjustable levels, with a minimum of 1 level and a maximum of 5 levels, press the intensity button to adjust.

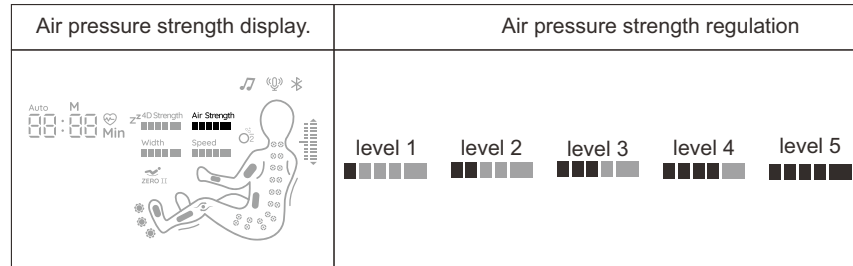

### V. Other Function (please use this function after the chair is turned on)

1. 4D intensity: short press the **"4D intensity"** key on the remote controller, then adjust the 4D intensity according to the massage needs, or rotate the armrest shortcut 4D intensity key to adjust the 4D intensity,

- (1). There are 1-5 levels of 4D intensity to choose, with level 1 indicating the weakest intensity and level 5 indicating the strongest intensity.
- (2). LCD interface displays 4D intensity.

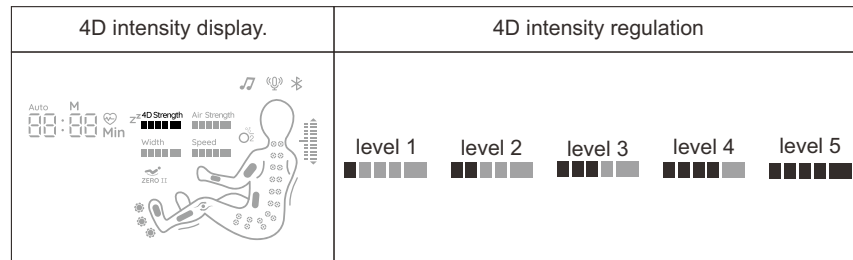

2. Heat: short press **"Heat"** key on the remote controller, open or close the heating function, or press the heating key on the armrest shortcut key to open or close heating.

- (1). LCD interface displays heating.

3. Calf kneading: short press **"calf kneading"** key on the remote controller, open or close the calf kneading function.

- (1). LCD interface displays calf kneading.

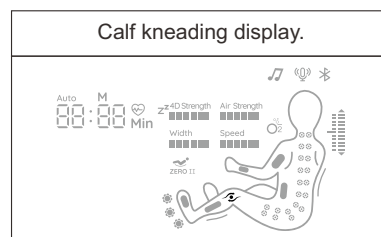
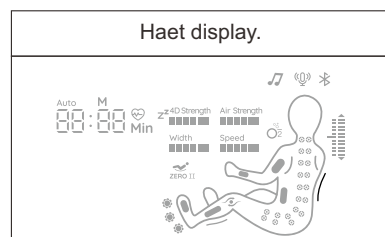

## Operation Instructions

4. Foot roller: Press **"Foot roller"** key to turn on or off the foot roller massage function, roller mode (fast, medium, slow, off).

- (1). LCD interface displays foot roller .

5. Shoulder position adjustment: press **"Up"** or **"Down"** keys to adjust the shoulder position, you can adjust the shoulder position if you feel it is not accurate when the back mechanism presses the shoulder.

- (1). LCD interface displays shoulder position adjustment .

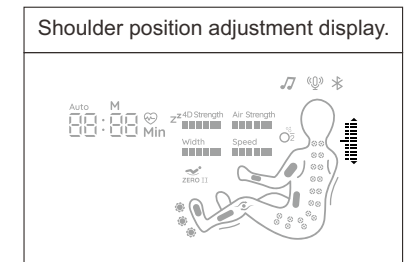
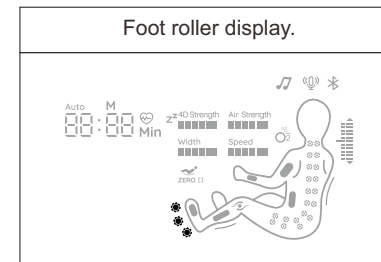

6. Time function: short press **"Time / Bluetooth"** key on the remote controller, and then adjust the massage timing time according to the massage needs, each press will be stacked for 5 minutes and Max. Is 40 minutes. If exceed 40 minutes, it will return to the lowest time value (5min).

- (1). Information interface displays massage timing.

7. Bluetooth function: Long press the **"Time/Bluetooth"** button on the remote controller to turn on or off the Bluetooth function. When the Bluetooth function is turned on, you can pair and connect the audio source device with Bluetooth function (such as a phone, MID tablet, etc.) to the massage chair Bluetooth module. The massage bluetooth speaker will play music.

- (1). Enter the smart device main menu. Open "Settings" and select the "Bluetooth" option. Open "Bluetooth", and Bluetooth will automatically "Search for a New Bluetooth Device".
- (2). The smart device will search for the corresponding Bluetooth model (e.g. IMCM-XXXX). Click the "Match" button. If you are asked whether to match with the device, you just select "Match" to complete matching.
- (3). Turn on "Music Player" in the smart device and select the song to play.
- (4). LCD interface displays bluetooth.

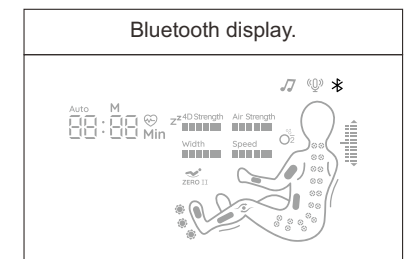
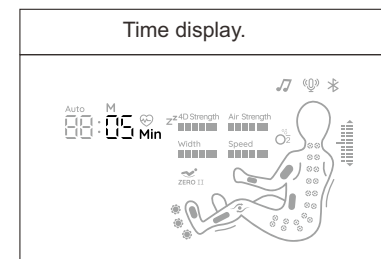

## Operation Instructions

8. volume adjustment: long press 3 seconds shoulder position “up key” or “down key” on the remote controller for volume adjustment, with a total of 0~15 adjustable levels.
9. Health detection: Press **"Health detection/ Voice broadcast"** key on remote control to start detection, then the health check signal will flash After entering the health check state, please keep your body relaxed. Gently place your index or middle finger on the sensor and the detect will start after several seconds. After the detection is completed, the health check signal is always on . Blood oxygen (1XXX refers to blood oxygen concentration), heart rate (0XXX stand for heart rate) and fatigue index (The whole test takes 40 to 60 seconds) will be displayed on the interface. There are four fatigue levels: “Good state,” “Mild fatigue,” “Moderate fatigue” and “Severe fatigue.” If you do not press the health check button within 10 seconds, automatic program will be recommended for you automatically according to your fatigue level. If you press the health check button within 10 seconds, it will be returned to the previous massage program. During the detecting process, you can also press the health check button to return to previous massage program. If the detection is not successful for more than 120 seconds, the detection is exited and returns to the previous massage state.
- Note: Recommended program: 1. Good: Total Relax (01), 2. Mild fatigue: Mild fatigue recovery (F1), 3. Moderate fatigue: Moderate fatigue recovery (F2), 4. Severe fatigue: Severe fatigue recovery (F3).

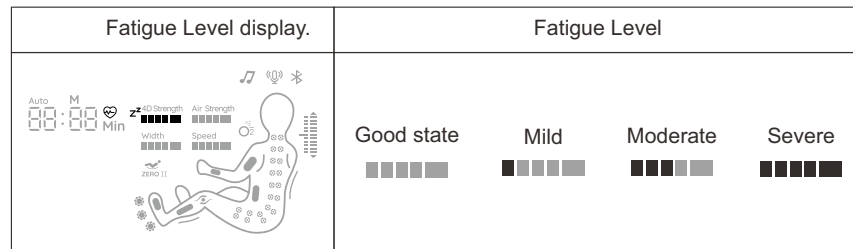

10. Voice broadcast: Long press the **"Health detection/Voice broadcast"** button to turn on or off the voice prompt function and background music function.
- (1). Voice prompt: During the user's use of the massage chair, it will prompt the user on how to use the massage chair correctly, helping new users become familiar with the massage function more quickly.
11. Voice: When the massage chair is turned on, short press the **"Voice"** button on the armrest shortcut key to wake up the voice assistant function (if unable to wake up the voice assistant, long press this button for 3 seconds to turn on the voice function). After turning on the voice assistant, say "Hi Alice /hey Alice" near the speaker position to wake up the voice assistant. When the voice assistant replies "I'm here", it means it has been awakened. After turning on the voice assistant, you can use the voice assistant function to control the massage chair.

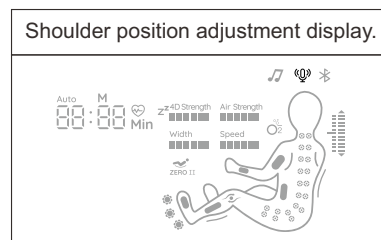
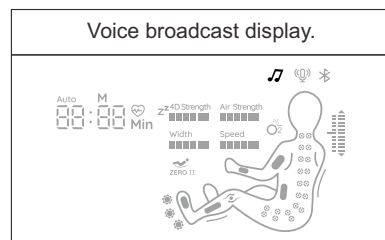

## Operation Instructions

- (1). After waking up the voice assistant, please say the command within 6s to realize the function control of the massage chair. You can continue to say a command after the voice assistant responds to the previous command, but the interval between two adjacent commands shall be no more than 6s, or you need to wake up the voice assistant again. The detailed list of voice commands is as follows:
- Attention: When awakening the voice control function, the speaking speed should not be too fast, and voice commands should be issued according to Voice Control Entry.

VOICE CONTROL ENTRY		
Entry: "Hi Alice" or "Hey Alice". Answer: I am here.		
No.	Voice control entry	Answer entry
1	Massage on	Answer: Ok, Massage on
2	Massage close	Answer: Ok, Massage close
3	Total Relax	Answer: Ok, Total Relax
4	Energy Boost	Answer: Ok, Energy Boost
5	Sweet Dream	Answer: Ok, Sweet Dream
6	Neck & Shoulder Care	Answer: Ok, Neck & Shoulder Care
7	Lunch Break	Answer: Ok, Lunch Break
8	Thai Massage	Answer: Ok, Thai Massage
9	Open the air pressure	Answer: Ok, Open the air pressure
10	Close the air pressure	Answer: Ok, Close the air pressure
11	Up the seat position	Answer: Ok, Up the seat position
12	Down the seat position	Answer: Ok, Down the seat position
13	Change the other mode	Answer: Ok, Change the other mode
14	Go little down	Answer: Ok, Go little down
15	Go little up	Answer: Ok, Go little up

Note: commands 14 and 15 can only be used after command 13.



## Operation Instructions

### VI. Double massage hand operation



1. Automatic mode: In auto mode, the upper and lower back mechanism run automatically according to the current program and cannot be manually adjusted.
2. Manual mode: In manual mode, press the "manual" key to switch the upper and lower back mechanism control. The manual icon "Manual", which is always on, represents the upper back mechanism control. There are four buttons (manual, position, up and down adjustment, 4D intensity) used to control the upper back mechanism, the manual icon flashing "Manual" represents the lower back mechanism control, and the four buttons (manual, position, up and down adjustment, 4D intensity) used to control the lower back mechanism.

### VII. Angle adjustment (please use this function after the chair is turned on)

#### 1. Leg mechanism angle



Function	Description
	Leg mechanism lowering key: Press and hold the leg mechanism lowered key of the remote control to start adjusting the leg downward, and the adjustment will stop when the key is released; the adjustment will stop and a "drip" sound will be heard when the adjustment reaches the limit position. After the downward is completed, the leg mechanism will automatically detect the length of the foot.
	Leg mechanism raising key: Press and hold the leg mechanism raised key of the remote control to start adjusting the leg upward, and the adjustment will stop when the key is released; the adjustment will stop and a "drip" sound will be heard when the adjustment reaches the limit position. After the downward is completed, the leg mechanism will automatically detect the length of the foot.

#### 2. Whole body angle

Function	Description
	Sitting position lowering key: Press and hold sitting position lowering key of the remote control to start adjusting the massage chair downward, the backrest mechanism will drop and the leg mechanism rise, and the adjustment will stop when the key is released; the adjustment will stop and a "drip" sound will be heard when the adjustment reaches the limit position. After the downward is completed, the leg mechanism will automatically detect the length of the foot.
	Sitting position raising key: Press and hold sitting position raising key of the remote control to start adjusting the massage chair upward, the backrest mechanism will up and the leg mechanism down, and the adjustment will stop when the key is released; the adjustment will stop and a "drip" sound will be heard when the adjustment reaches the limit position. After the upward is completed, the leg mechanism will automatically detect the length of the foot.

## Operation Instructions

### 3. Leg unit extension/shortening adjustment

Key	Description
	Leg unit shortening key: remotely adjust shortening of the leg unit; press and hold this key to move the leg unit up slowly and stop when released. When the adjustment reaches the limit position, the adjustment will stop and beeps will be emitted.
	Leg unit extension key: remotely adjust extension of the leg unit; press and hold this key to move the leg unit down slowly and stop when released. When the adjustment reaches the limit position, the adjustment will stop and beeps will be emitted.

### VIII. End the massage

During the massage:

1. Short press the power button on the hand controller to turn off all massage functions and reset the massage chair angle.
2. Short press the power button on the armrest to turn off all massage functions and reset the massage chair angle.
3. As the timing ends, all massage functions stop, and the angle of the massage chair will be not return to original position.

Cut off the whole machine power supply, as shown in the figure (Schematic diagram of power switch position of the whole machine).

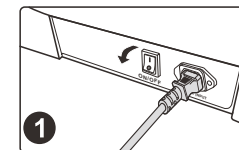

1 Turn off the power switch ("0" position)

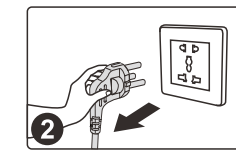

2 Schematic diagram of pulling out the power plug

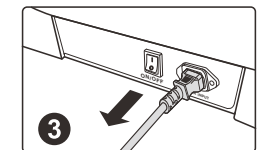

3 Remove the product connection power cord

## Cleaning and Maintenance

### Cleaning synthetic leather and plastic parts

Wipe the leather with a soft, dry cloth.

- Do not use chemicals such as thinner, gasoline, alcohol, etc. to clean the unit.
- When using commercially available leather care products (rags), please follow the instructions for use.
- If synthetic leather is particularly dirty, wipe it in the following way.
  - ① Immerse a soft cloth in water or hot water containing 3% to 5% neutral detergent, then wring it out thoroughly.
  - ② Use the above soft cloth to wipe the leather surface.
  - ③ Wipe off the cleaning solution with a cloth soaked in clean water and thoroughly wrung out.
  - ④ Wipe with a wrung soft cloth.
  - ⑤ Let it air dry naturally.
- When it is difficult to remove stains, please immerse commercially available melamine foam in neutral detergent, and then wipe the machine with it.
- Do not use a hair dryer to dry the surface.
- Be careful when wiping the machine with denim and colored fabrics, as the color of the fabric will stain the surface of the synthetic leather.
- Do not keep these parts in contact with plastic for a long time, as this will cause discoloration.
- Synthetic leather may be discolored, so when using hair dye, please cover the touched part with a towel.

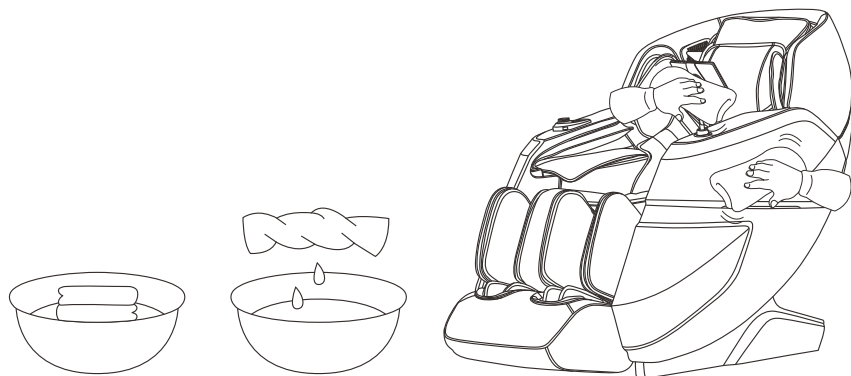

## Troubleshooting

<b>Fault</b>	When the calf mechanism or the backrest reaches a certain position, press the corresponding adjustment button and it will no longer change, and a continuous "beep, beep" sound will be emitted.
<b>Solution</b>	Due to product structure design and ergonomic requirements, this product has a limited protection design for the limit state of attitude adjustment. At the same time, a reminder sound will sound when the limit is reached.

<b>Fault</b>	The function does not work or some functions do not work after the machine is turned on.
<b>Solution</b>	After the machine is turned on by pressing the switch key, it is necessary to manually select an automatic massage program or other working state. If it is not operated, the machine will automatically shut down after 20 minutes. If the manual operation mode is selected, the functions that are not selected may be disabled, and the working mode needs to be manually set in the manual mode.

<b>Fault</b>	The machine makes a leather rubbing sound when adjusting its posture.
<b>Solution</b>	This product adopts high-grade anti-corrosion leather that meets environmental protection requirements. Due to the inherent characteristics of leather materials, there will be a normal slight noise when rubbing at the relative movement, which is a normal phenomenon. Note: If you hear fabric or leather tearing sound when the machine is running, please stop using it immediately and seek professional maintenance.

<b>Fault</b>	The massage wheel did not reach the shoulders or neck.
<b>Solution</b>	If the head does not touch the head cushion or the back does not touch the backrest, the shoulder position may be lower than the actual position during the body shape detection process. Sit in the deepest position of the seat, rest your head on the headrest, and start over from the beginning.

<b>Fault</b>	The unit is damaged. The power cord or power plug is abnormally hot.
<b>Solution</b>	To prevent accidents, be sure to contact an authorized service center.

Please feel free to contact the designated service personnel for any questions or doubts about this product.

## Product specifications

---

Model: SL-A520-32

Name: Massage Chair

Rated voltage: 110-120V~ 60Hz

220-240V~ 50Hz/60Hz

Rated power: 150W

Rated time: 20min

Safety structure: Class I